

vtech[®]

Instruction Manual

Secret Safe Magic Notebook



VTech understands that a child's needs and abilities change as they grow and with that in mind we develop our toys to teach and entertain at just the right level...

vtech Baby

Toys that will stimulate their interest in different textures, sounds and colours

I am...

...responding to colours, sounds and textures

...understanding cause and effect

...learning to touch, reach, grasp, sit-up, crawl and toddle

Birth-36 months



Pre-School

Interactive toys to develop their imagination and encourage language development

I want...

...to get ready for school by starting to learn the alphabet and counting

...my learning to be as fun, easy and exciting as can be

...to show my creativity with drawing and music so my whole brain develops

3-6 years



Electronic Learning Computers

Cool, aspirational and inspiring computers for curriculum related learning

I need...

...challenging activities that can keep pace with my growing mind

...intelligent technology that adapts to my level of learning

...National Curriculum based content to support what I'm learning at school

4-10 years



To learn more about this and other VTech® products, visit www.vtech.co.uk

INTRODUCTION

With the **Secret Safe Magic Notebook** by **VTECH®**, your secrets are safe! Only you can unlock your notebook with your secret passcode! Write all your secrets in the 30 page notebook, and for super secrets, use the invisible ink pen to write secret messages that can only be seen using the magic light! Get creative with the music activity, play games, find your lucky number and hear daily advice! A secret notebook has never been so magical!

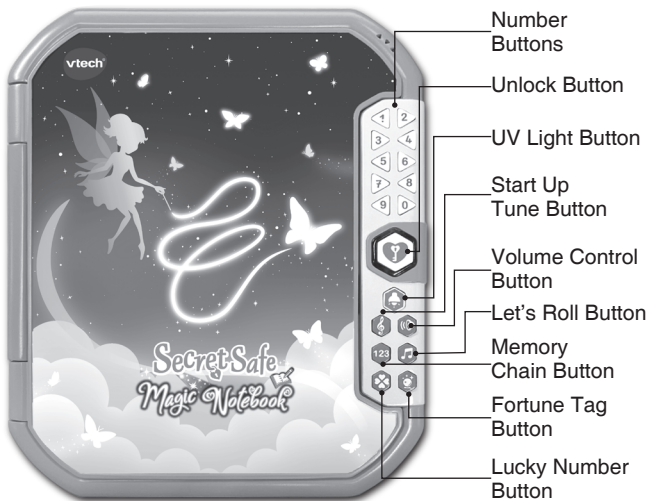

Notebook



Invisible ink pen



Reset Button
(at the back of the unit)

INCLUDED IN THIS PACKAGE

- One Secret Safe Magic Notebook
- Quick Start Guide

WARNING:

All packing materials such as tape, plastic sheets, packaging locks, removable tags, cable ties, cords and packaging screws are not part of this toy and should be discarded for your child's safety.

NOTE:

Please save this Instruction Manual as it contains important information.

Unlock the Packaging Locks

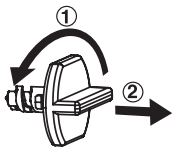

- ① Rotate the packaging locks 90 degrees anticlockwise.
- ② Pull out the packaging locks and discard.

GETTING STARTED

The unit is in try-me mode in the packaging. Open the battery cover, then press and hold the reset button for 1 second, the passcode will be cleared and the notebook cover will open. This confirms that try-me mode has been exited.

BATTERY REMOVAL AND INSTALLATION

1. Make sure the unit is turned OFF.
2. Locate the battery cover on the back of the unit. Use a screwdriver to loosen the screw and then open the battery cover.
3. If used batteries are present, remove these batteries from the unit by pulling up on one end of each battery.
4. Install 3 new AA (LR6/AM-3) batteries following the diagram inside the battery box. (For best performance, alkaline batteries or fully charged Ni-MH rechargeable batteries are recommended).
5. Replace the battery cover and tighten the screw to secure.

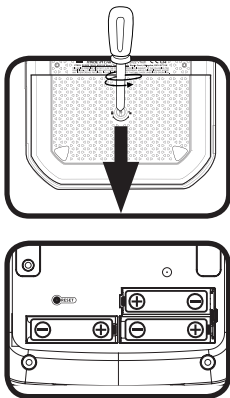

WARNING:

Adult assembly required for battery installation.
Keep batteries out of reach of children.

- Insert batteries with the correct polarity (+ and -).
- Do not mix old and new batteries.
- Do not mix alkaline, standard (carbon-zinc) or rechargeable batteries.
- Only batteries of the same or equivalent type as recommended are to be used.
- Do not short-circuit the supply terminals.
- Remove batteries during long periods of non-use.
- Remove exhausted batteries from the toy.
- Dispose of batteries safely. Do not dispose of batteries in fire.

RECHARGEABLE BATTERIES:

- Remove rechargeable batteries from the toy before charging.
- Rechargeable batteries are only to be charged under adult supervision.
- Do not charge non-rechargeable batteries.

Disposal of batteries and product



The crossed-out wheellie bin symbols on products and batteries, or on their respective packaging, indicates they must not be disposed of in domestic waste as they contain substances that can be damaging to the environment and human health.

The chemical symbols Hg, Cd or Pb, where marked, indicate that the battery contains more than the specified value of mercury (Hg), cadmium (Cd) or lead (Pb) set out in the Batteries and Accumulators Regulation.



The solid bar indicates that the product was placed on the market after 13th August, 2005.

Help protect the environment by disposing of your product or batteries responsibly.

VTech® cares for the planet.

Care for the environment and give your toy a second life by disposing of it at a small electricals collection point so all its materials can be recycled.

In the UK:

Visit www.recyclenow.com to see a list of collection points near you.

In Australia & New Zealand:

Check with your local council for kerbside collections.

Product Features

1. UNLOCK BUTTON

Press the **Unlock Button**, then input your number passcode to unlock the unit.

2. NUMBER BUTTONS

Input your number passcode to unlock the unit and play in the related games.



3. UV LIGHT BUTTON

Press the **UV Light Button** to toggle the UV Light on and off.

4. VOLUME CONTROL BUTTON

Press the **Volume Control Button** to toggle between Low and High volume.

5. START UP TUNE BUTTON

Press the **Start Up Tune Button** to enter this mode and press any number buttons to create your own start up tune.

6. LET'S ROLL BUTTON

Press the **Let's Roll Button** to enter this mode and hear music.

7. MEMORY CHAIN BUTTON

Press the **Memory Chain Button** to enter this mode and play the Memory Chain number game.

8. LUCKY NUMBER BUTTON

Press the **Lucky Number Button** to enter this mode and find out your lucky number!

9. FORTUNE TAG BUTTON

Press the **Fortune Tag Button** to enter this mode and find out your fortune!

10. RESET BUTTON

Press the **Reset Button** between 1-2 seconds to clear the number passcode on the unit. If successful, you will hear “Passcode reset” and the cover will open.



11. AUTOMATIC SHUT-OFF

To preserve battery life, the unit will automatically power-off after several minutes without input. The unit can be turned on again by pressing any button.

12. NOTEBOOK REPLACEMENT

You can replace the included notebook with a standard A6 size notebook. The maximum recommended page count of a replacement notebook is 100 pages (50 sheets). There are two book holders to secure the replacement notebook. Please make sure that the replacement notebook has been inserted into the two book holders when replacing the notebook.

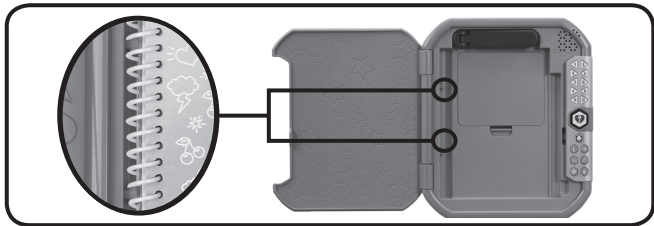

13. SECRET COMPARTMENT

Store your items in the compartment to keep them secret and safe.

Note:

If the unit repeatedly powers down while playing, please install a brand new set of batteries and try switching it on again.

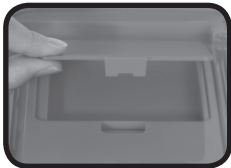

14. PEN HOLDER

Keep your pen in this holder.

ACTIVITIES

1. START UP TUNE Mode

Choose different music notes to create your own start up tune to customise your Secret Safe Magic Notebook! Anytime, you open your notebook, you will hear your own tune!

2. LET'S ROLL Mode

Listen to the 10 built-in melodies whilst writing your notes! You can press any button to hear different melodies.

3. MEMORY CHAIN Mode

Challenge your memory in this game. You can play this game solo, or with a friend. Will you remember the number sequence? Memorise the number sequence and repeat it!

4. LUCKY NUMBER Mode

This Magic Notebook will ask you a magic equation, when you answer it correctly, it will reveal your lucky number.

5. FORTUNE TAG Mode

Choose a number to receive your fortune!

CARE & MAINTENANCE

1. Keep the unit clean by wiping it with a slightly damp cloth.
2. Keep the unit out of direct sunlight and away from any direct heat source.
3. Remove the batteries when the unit is not in use for an extended period of time.
4. Do not drop the unit on hard surfaces and do not expose the unit to moisture or water.

TROUBLESHOOTING

If for some reason the program/activity stops working, please follow these steps:

1. Please turn the unit OFF.
2. Interrupt the power supply by removing the batteries.
3. Let the unit stand for a few minutes, then replace the batteries.
4. Turn the unit ON. The unit should now be ready to play with again.
5. If the product still does not work, please install a brand new set of batteries.

If the problem persists, please contact our Consumer Services Department and a service representative will be happy to help you.

CONSUMER SERVICES

Creating and developing **VTech®** products is accompanied by a responsibility that we at **VTech®** take very seriously. We make every effort to ensure the accuracy of the information, which forms the value of our products. However, errors sometimes can occur. It is important for you to know that we stand behind our products and encourage you to call our Consumer Services Department with any problems and/or suggestions that you might have. A service representative will be happy to help you.

UK Customers:

Phone: 0330 678 0149 (from UK) or +44 330 678 0149 (outside UK)

Website: www.vtech.co.uk/support

Australian Customers:

Phone: 1800 862 155

Website: support.vtech.com.au

NZ Customers:

Phone: 0800 400 785

Website: support.vtech.com.au

PRODUCT WARRANTY/ CONSUMER GUARANTEES

UK Customers:

Read our complete warranty policy online at vtech.co.uk/warranty.

Australian Customers:

VTECH ELECTRONICS (AUSTRALIA) PTY LIMITED –
CONSUMER GUARANTEES

Under the Australian Consumer Law, a number of consumer guarantees apply to goods and services supplied by VTech Electronics (Australia) Pty Limited. Please refer to vtech.com.au/consumerguarantees for further information.

**Visit our website for more
information about our products,
downloads, resources and more.**

www.vtech.co.uk
www.vtech.com.au



TM & © 2022 VTech Holdings Limited.
All rights reserved.
IM-532400-001
Version: 0